

Parts Breakdown

Model **FR-CN-0600-2** 48376

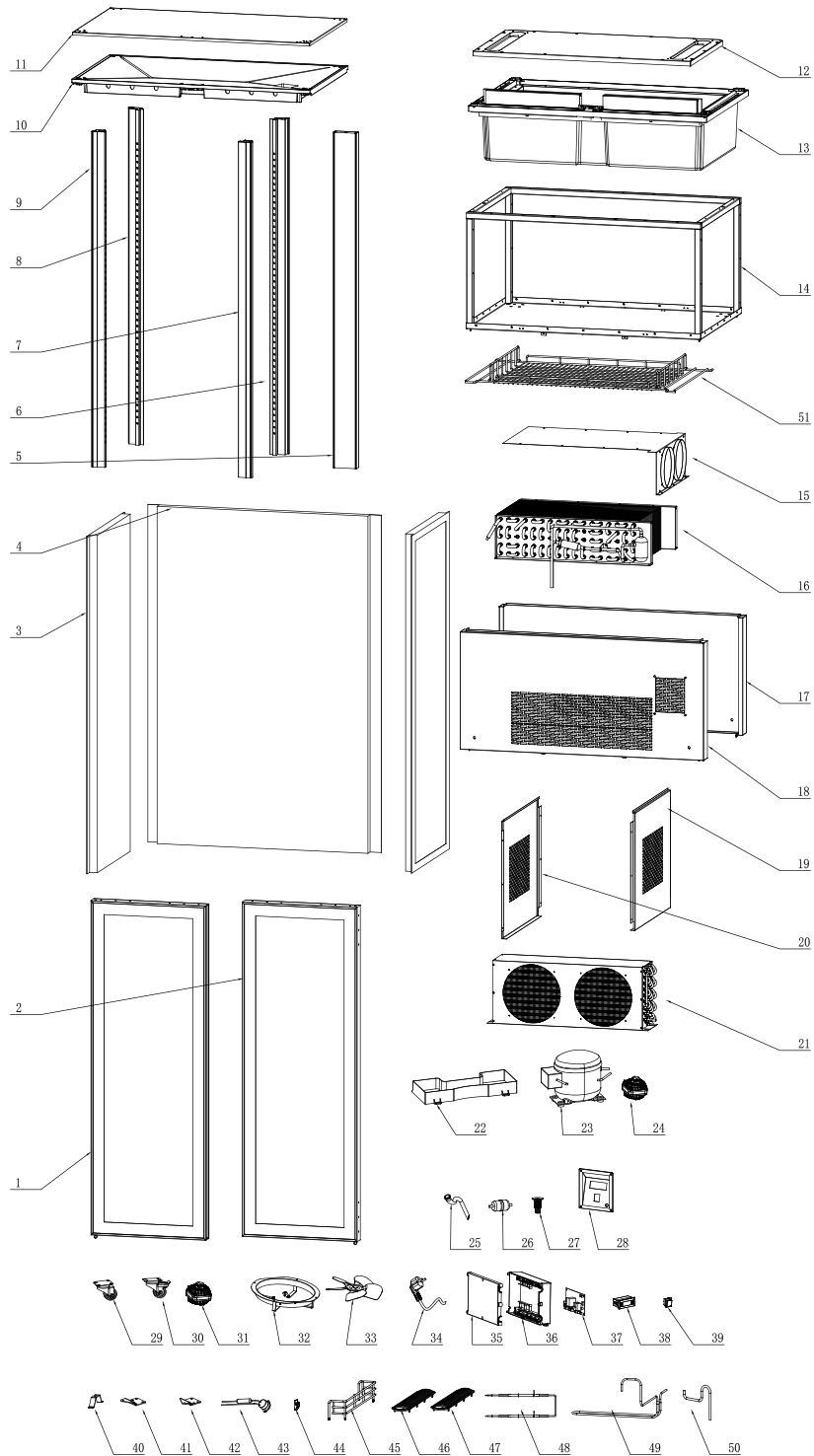

Parts Breakdown

Model FR-CN-0600-2 48376

Item No.	Description	Position	Item No.	Description	Position	Item No.	Description	Position
AR503	Left Door Assembly for 48376	1	AR520	Right Frame for 48376	20	AL832	Mainboard for 48376	37
AR504	Right Door Assembly for 48376	2	AR521	Condenser for 48376	21	AR356	Display for 48376	38
AR505	Side Glass for 48376	3	AR522	Water Box for 48376	22	AL834	Switch for 48376	39
AR506	Back Glass for 48376	4	AR523	Compressor for 48376	23	AR528	Evaporator Motor Supporter for 48376	40
AR507	Middle Pillar Foaming Assembly for 48376	5	AR524	Motor for 48376	24	AR529	Left Upper Hinge for 48376	41
AR508	Front Pillar Foaming Assembly for 48376	6, 8	AL817	Water Leakage Pipe for 48376	25	AR530	Right Upper Hinge for 48376	42
AR509	Back Pillar Foaming Assembly for 48376	7, 9	AR396	Dry Filter for 48376	26	AR531	Thermostat Assembly for 48376	43
AR510	Top Foaming Cover Assembly for 48376	10	AL819	Water Leakage Pipe Joint for 48376	27	AR532	Shelf Clips for 48376	44
AR511	Top Cover for 48376	11	AR525	Switch Panel for 48376	28	AR533	Raising Guard for 48376	45
AR512	Ventilating Board Foaming for 48376	12	AR333	Castor for 48376	29	AR534	Air Inlet for 48376	46
AR513	Evaporator Foaming Components for 48376	13	AR526	Caster for 48376	30	AR535	Air Outlet for 48376	47
AR514	Base Components for 48376	14	AR527	Motor for 48376	31	AR536	Heating Element for 48376	48
AR515	Motor Fixed Board for 48376	15	AL827	Flange for 48376	32	AR537	High Pressure Tube for 48376	49
AR516	Evaporator for 48376	16	AL828	Condenser Fan for 48376	33	AR538	Suction Tube for 48376	50
AR517	Back Frame for 48376	17	AR331	Power Line for 48376	34	AR539	Shelf for 48376	51
AR518	Front Frame for 48376	18	AL831	Base of Assembly Box for 48376	35			
AR519	Left Frame for 48376	19	AL830	Cover of Assembly Box for 48376	36			